

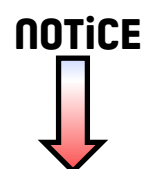

MARQUE: **TEFAL**
REFERENCE: **PP1149V0**
CODiC: **4585674**



Tefal®



CLASSIC

Notice d'utilisation • Instruction manual
Инструкция по эксплуатации

www.tefal.com

2015900756-01

FR PARTICIPONS À LA PROTECTION DE L'ENVIRONNEMENT !



- ① Votre appareil contient de nombreux matériaux valorisables ou recyclables.
② Confiez celui-ci dans un point de collecte ou à défaut dans un Centre Service Agréé pour que son traitement soit effectué.

Ne pas jeter les piles usées : traitez-les comme des résidus chimiques.
Apportez les à un point de collecte prévu à cet effet.

EN ENVIRONMENT PROTECTION FIRST!



- ① Your appliance contains valuable materials which can be recovered or recycled.
② Leave it at a local civic waste collection point.

Never throw used batteries into the dustbin: consider them as chemical residue.
Take them to a recognised collection point.

NL WEES VRIENDELIJK VOOR HET MILIEU!



- ① Uw apparaat bevat materialen die geschikt zijn voor hergebruik.
② Lever het in bij het milieustation in uw gemeente of bij onze technische dienst.

Werp lege batterijen niet weg: verwerk ze als klein chemisch afval.
Breng ze naar een speciaal, centraal afvalinzamelpunt.

DE DENKEN SIE AN DEN SCHUTZ DER UMWELT!



- ① Ihr Gerät enthält wertvolle Rohstoffe, die wieder verwertet werden können.
② Geben Sie Ihr Gerät deshalb bitte bei einer Sammelstelle Ihrer Stadt oder Gemeinde ab.

Werfen Sie die leeren Batterien nicht in den Hausmüll, sondern entsorgen Sie diese bei einer Sondermüll-Sammelstelle, Ihrer Stadt oder Gemeinde.
Bringen Sie es zu einer hierfür vorgesehenen Sammelstelle.

IT PARTECIPIAMO ALLA PROTEZIONE DELL' AMBIENTE !



- ① Il vostro apparecchio è composto da diversi materiali che possono essere riciclati.
② Lasciatelo in un punto di raccolta o presso un Centro Assistenza Autorizzato.

Non gettate le pile scariche nella spazzatura: maneggiatele come residui chimici.
Consegnararli a un centro di raccolta preposto.

ES !! PARTICIPE EN LA CONSERVACIÓN DEL MEDIO AMBIENTE !!



- ① Su electrodoméstico contiene materiales recuperables y/o reciclables.
② Entregúelo al final de su vida útil, en un Centro de Recogida Específico o en uno de nuestros Servicios Oficiales Post Venta donde será tratado de forma adecuada.

No tirar las pilas usadas a la basura normal: desecharlas como residuos químicos.
Deposítelos en un punto de recogida previsto al efecto.

PT PROTECÇÃO DO AMBIENTE EM PRIMEIRO LUGAR !



- ① O seu aparelho contém materiais que podem ser recuperados ou reciclados.
② Entregue-o num ponto de recolha para possibilitar o seu tratamento.

Não deitar fora as pilhas usadas: Tratá-las como resíduos químicos.
Entregue-as num ponto de recolha previsto para este efeito.

DA VI SKAL ALLE VÆRE MED TIL AT BESKYTTE MILJØET!



- ① Apparatet indeholder mange materialer, der kan genvindes eller genbruges.
② Bring det til et specialiseret indsamlingssted for genbrug eller et autoriseret servic værksted, når det ikke skal bruges mere.

Dette apparat fungerer med en eller flere batterier. Kast dem ikke bort, men bring dem til et specialiseret indsamlingssted for at beskytte miljøet.

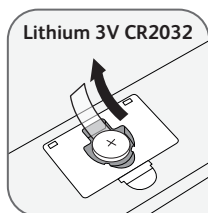
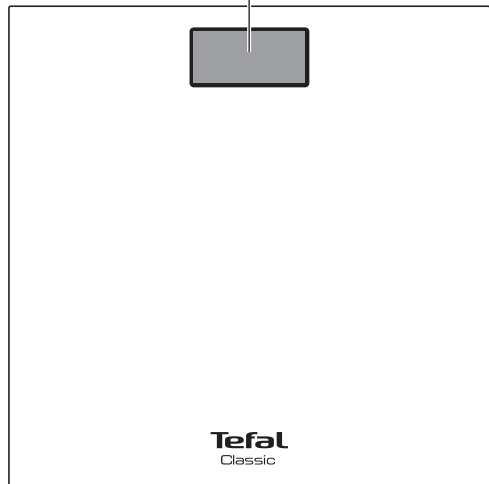
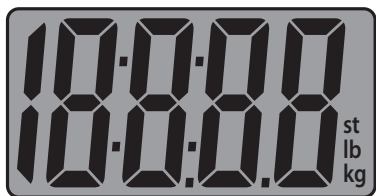

1st USE
1^{ère} UTILISATION
ПЕРВОЕ ИСПОЛЬЗОВАНИЕ

1 UTILISATION / USE / ИНСТРУКЦИЯ

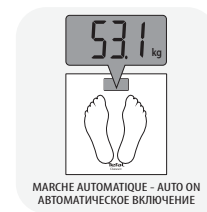
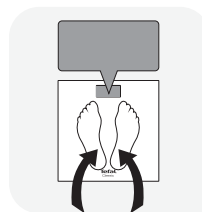

MARCHE AUTOMATIQUE - AUTO ON
АВТОМАТИЧЕСКОЕ ВКЛЮЧЕНИЕ

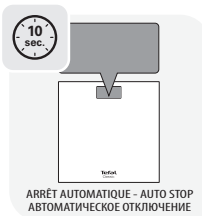
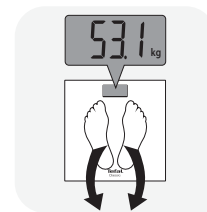

ARRÊT AUTOMATIQUE - AUTO STOP
АВТОМАТИЧЕСКОЕ ОТКЛЮЧЕНИЕ

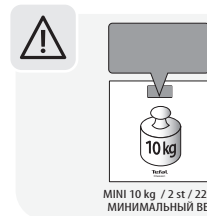

MINI 10 kg / 2 st / 22 lb
МИНИМАЛЬНЫЙ ВЕС

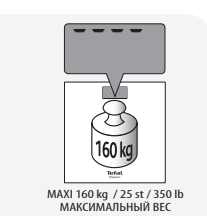

MAXI 160 kg / 25 st / 350 lb
МАКСИМАЛЬНЫЙ ВЕС

2 UNITÉS / UNITS / БЛОК (kg > st.lb > lb)

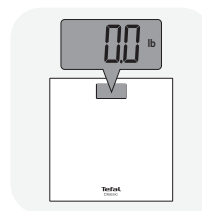
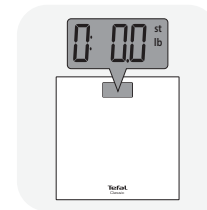
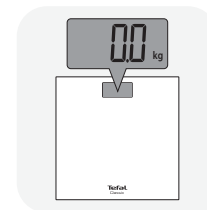
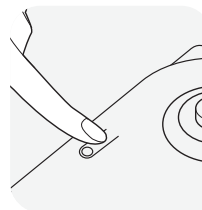

kg > st.lb > lb

3 PILE / BATTERY / БАТАРЕИ

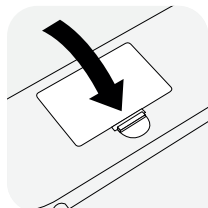
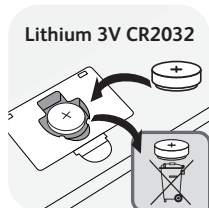
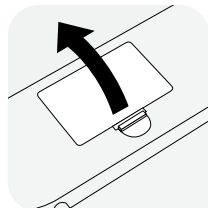
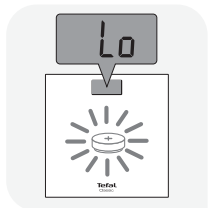

5 INTERDICTIONS / FORBIDDEN / ЗАПРЕЩЕНО

