

JBL

CASQUE HIFI FREE X BLK BT

MANUEL D'UTILISATION



Besoin d'aide ?

Rendez-vous sur votre communauté <https://sav.darty.com>





FREE



FREE

Quick Start Guide

Guide de démarrage rapide

1 What's in the box

FREE

Charging Case



x 1



x 1

Gel Sleeves

Ear Tips



L

M

x 2 pairs



L

M

S

x 3 pairs

Charging Cable



x 1

Warranty card, Warning card, Safety sheet, QSG



x 1

FREE

Quick Start Guide

Guide de démarrage rapide

2 Customize your fit

- a. Mix and match ear tips and silicone sleeves for a perfect fit and audio performance.

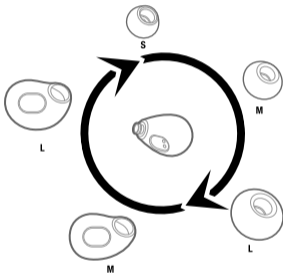

- b. Installation

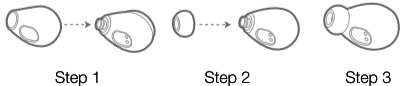

FREE

Quick Start Guide

Guide de démarrage rapide

3 Wireless Device Pairing

a. First time pairing with device:

Step 1 - Ensure to give the ear pieces a full charge before initiating pairing.

*Ear pieces and charging case are packed separately.

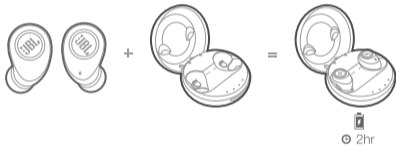

Step 2 - Remove right ear piece from case, it will turn on automatically, entering pairing mode (alt. blue/white).

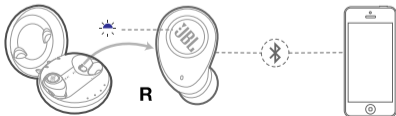

FREE

Quick Start Guide

Guide de démarrage rapide

Step 3 - From device, go to Bluetooth menu.

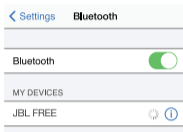
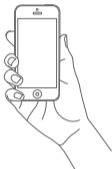

Choose "JBL FREE" to connect

Step 4 - Remove **left** ear piece from case, it will automatically connect with the right ear piece.

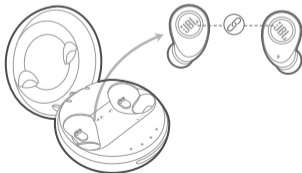

FREE

Quick Start Guide

Guide de démarrage rapide

b. From second time onwards:

Wireless connections are automatically established when the headphones are taken out of the case.

c. Ear pieces automatically power off and recharge when put in the charging case.

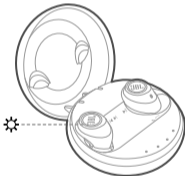

* To turn on ear pieces manually, long press the button on ear piece for 5s.

FREE

Quick Start Guide

Guide de démarrage rapide

4 a. Buttons

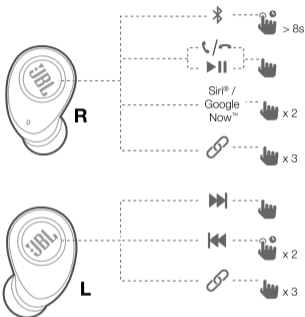

b. Manual power on and off



FREE

Quick Start Guide

Guide de démarrage rapide

5 Charging

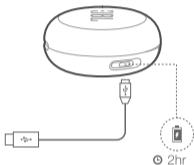

6 Manual controls for special situations

- a. Manual Bluetooth pairing to device when ear pieces do not pair automatically. 

FREE

Quick Start Guide

Guide de démarrage rapide

Step 1 - Long press (>8s) right ear piece button when powered off

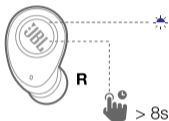

Step 2 - Choose JBL FREE



Choose "JBL FREE" to connect

FREE

Quick Start Guide

Guide de démarrage rapide

- b. Manual pairing of left and right ear pieces when connection is **lost**. 

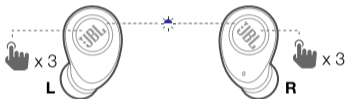

- c. Manual power off.



FREE

Quick Start Guide

Guide de démarrage rapide

FR

Jumelage d'un appareil sans fil

a. Premier jumelage d'un appareil :

Étape 1 - Vérifiez que les écouteurs sont complètement chargés avant de tenter un jumelage.

*Les écouteurs et le boîtier de charge sont emballés séparément.

Étape 2 - Retirez l'écouteur droit du boîtier, il s'allume automatiquement et passe en mode de jumelage (alternance de bleu et blanc).

Étape 3 - Sur la source, allez dans le menu Bluetooth. Choisissez «JBL FREE» pour vous connecter.

Étape 4 - Retirez l'oreillette gauche du boîtier, elle se connecte automatiquement à l'oreillette droite.

b. Dès la seconde fois :

Les connexions sans fils sont automatiquement établies lorsque les écouteurs sont sortis du boîtier."

c. Les oreillettes s'éteignent automatiquement et se rechargent lorsqu'elles sont dans le boîtier de charge.

* Pour allumer l'écouteur manuellement, appuyez 5 secondes sur son bouton.

Commandes manuelles pour situations spécifiques

a. Jumelage Bluetooth manuel de l'appareil

Étape 1 - Pression longue (>8 s) sur le bouton d'oreillette droite.

Étape 2 - Choisissez JBL FREE.

b. Jumelage manuel des écouteurs droits et gauches lorsque la connexion est perdue.

c. Mise hors tension manuelle.

FREE

Quick Start Guide

Guide de démarrage rapide

7 a. LED Behaviors



| State | | LED behaviors |
|------------------|---|-----------------------------|
| Charging | | ● Solid white |
| Device pairing | 📶 | ☀️ Blue/white flash |
| Device connected | 🔗 | ☀️ Blue fade in / fade out |
| Battery low | 🔋 | ☀️ White fade in / fade out |

FR

| État | | Signification des LED |
|---------------------|---|----------------------------|
| Recharge | | ● Blanc fixe |
| Jumelage d'appareil | 📶 | ☀️ Clignotement bleu/blanc |
| Appareil connecté | 🔗 | ☀️ Pulsations bleues |
| Batterie faible | 🔋 | ☀️ Pulsations blanches |

ES

| Estado | | Comportamientos del LED |
|--------------------------------|---|--------------------------------------|
| Cargando | | ● Blanco fijo |
| Emparejamiento de dispositivos | 📶 | ☀️ Parpadeo azul/blanco |
| Dispositivo conectado | 🔗 | ☀️ Encendido/apagado lento en azul |
| Batería baja | 🔋 | ☀️ Encendido/apagado lento en blanco |

DE

| Zustand | | LED-Verhalten |
|-----------------------|---|------------------------|
| Aufladen | | ● Konstant weiß |
| Gerätekopplung | 📶 | ☀️ Blau/weiß blinkend |
| Gerät verbunden | 🔗 | ☀️ Blau zu-/ abnehmend |
| Batteriestand niedrig | 🔋 | ☀️ Weiß zu-/ abnehmend |

IT

| Stato | | Comportamento LED |
|----------------------------------|---|--------------------------------------|
| In carica | | ● bianco fisso |
| Sincronizzazione con dispositivo | 📶 | ☀️ Blu/bianco lampeggiante |
| Dispositivo connesso | 🔗 | ☀️ Blu in aumento/ in diminuzione |
| Batteria scarica | 🔋 | ☀️ Bianco in aumento/ in diminuzione |

NL

| Status | | LED-gedrag |
|----------------------|---|----------------------------|
| Opladen | | ● continu wit |
| Apparaat koppelen | 📶 | ☀️ Blauw/wit knipperend |
| Apparaat aangesloten | 🔗 | ☀️ Blauw fade in/ fade out |
| Batterij bijna leeg | 🔋 | ☀️ Wit fade in/ fade out |

NO

| Status | | LED-atferd |
|----------------------|---|--------------------------------|
| Lading | | ● lysert hvitt |
| Enhetsparing | 📶 | ☀️ Blinker blått/hvitt |
| Enheten er tilkoblet | 🔗 | ☀️ Blått, toner inn / toner ut |
| Lavt batteri | 🔋 | ☀️ Hvitt, toner inn / toner ut |

FREE

Quick Start Guide

Guide de démarrage rapide

b. Charging case: LED behavior

EN

| LED(s) | Battery Status | Power On |
|--------|----------------|----------|
| LED 1 | <25% | ● On |
| LED 2 | 50% | ● On |
| LED 3 | 75% | ● On |
| LED 4 | 100% | ● On |

Warning: Switch off the charging case when not in use to avoid battery damage.

ES

| LED(s) | Estado de la batería | Encendido |
|--------|----------------------|-------------|
| LED 1 | <25% | ● Encendido |
| LED 2 | 50% | ● Encendido |
| LED 3 | 75% | ● Encendido |
| LED 4 | 100% | ● Encendido |

Advertencia: Apaga el estuche de carga mientras no se utilice para evitar daños en la batería.

FR

| LED(s) | État de la batterie | Marche |
|--------|---------------------|----------|
| LED 1 | <25% | ● MARCHE |
| LED 2 | 50% | ● MARCHE |
| LED 3 | 75% | ● MARCHE |
| LED 4 | 100% | ● MARCHE |

Avertissement : Éteignez le boîtier de charge lorsqu'il n'est pas utilisé afin de ne pas endommager la batterie.

DE

| LED(s) | Akkustatus | Einschalten |
|--------|------------|-------------|
| LED 1 | <25% | ● EIN |
| LED 2 | 50% | ● EIN |
| LED 3 | 75% | ● EIN |
| LED 4 | 100% | ● EIN |

Warnung: Schalte die Ladeschale bei Nichtgebrauch aus, um Schäden an den Akkus zu vermeiden.

FREE

Quick Start Guide

Guide de démarrage rapide

EN

- Model: JBL FREE X
- Bluetooth version: 4.2
- Support: A2DP V1.3, AVRCP V1.5, HFP V1.6
- Headset Battery type: Lithium-ion polymer (3.7V, 85mA)
- Bluetooth transmitter power < 9.5dBm
- Bluetooth transmitter frequency range: 2.402 – 2.480GHz
- Bluetooth transmitter modulation: GFSK, $\pi/4$ DQPSK, 8DPSK
- Dynamic drivers: 5.6mm
- Frequency Response: 10Hz – 22 kHz
- Charging case battery: 1,500 mA (est)
- Earbuds Battery life: Up to 4 hours
- Charging time: < 2 hours
- **Compatibility:** Use with Phones, Tablets, Computers
- Weight : 99g

FR

- Modèle : JBL FREE X
- Version Bluetooth : 4.2
- Support : A2DP V1.3, AVRCP V1.5, HFP V1.6
- Type de batterie du casque : Lithium-ion polymère (3,7 V, 85 mA)
- Puissance de l'émetteur Bluetooth < 9,5 dBm
- Bande de fréquences de l'émetteur Bluetooth : 2,402 - 2,480 GHz
- Modulation de l'émetteur Bluetooth : GFSK, $\pi/4$ DQPSK 8DPSK
- Haut-parleurs dynamiques : 5,6 mm
- Réponse en fréquence : 10 Hz - 22 kHz
- Batterie du boîtier de charge : 1 500 mA (env.)
- Autonomie de batterie des écouteurs : jusqu'à 4 heures
- Durée de la charge : < 2 heures
- **Compatibilité :** Utilisation avec des téléphones, tablettes, ordinateurs
- Poids (g) : 99 g

FREE

Quick Start Guide

Guide de démarrage rapide

AR

- الطراز: JBL FREE X
- إصدار البلوتوث: 4.2
- الدعم: A2DP V1.3, AVRCP V1.5, HFP V1.6
- نوع بطارية سماعة الرأس: ليثيوم أيون بوليمر (3.7 فولت، 85 مللي أمبير)
- طاقة جهاز إرسال بلوتوث > 9.5 ديسيبل مللي
- النطاق الترددي لجهاز إرسال بلوتوث: 2480 – 2.402 هرتز
- ضبط وحدات جهاز إرسال بلوتوث: GFSK, π/4 DQPSK, 8DPSK
- مُشغلات ديناميكية: 5.6 مم
- استجابة التردد: 10 هرتز - 22 كيلوهرتز
- بطارية غلبة الشحن: 1.500 مللي أمبير (وحدة ضبط الإشعاع est)
- عمر بطارية سماعات الأذن: حتى 4 ساعة
- زمن الشحن: > 2 ساعات
- التوافق: تُستخدم مع الهواتف والأجهزة اللوحية وأجهزة الكمبيوتر
- الوزن (جرام): 99 جرام

| | |
|--------------------------------|--|
| Торговая марка | : JBL |
| Назначение товара | : Пользовательские наушники |
| Изготовитель | : Харман Интернешнл Индастриз Инкорпорейтед, США, 06901 Коннектикут, г.Стэмфорд, Атлантик Стрит 400, офис 1500 |
| Страна происхождения | : Китай |
| Импортер в Россию | : ООО *ХАРМАН РУС СиАйЭс*, Россия, 127018, г.Москва, ул. Двинцев, д.12, к 1 |
| Гарантийный период | : 1 год |
| Информация о сервисных центрах | : www.harman.com/ru тел. +7-800-700-0467 |
| Срок службы | : 2 года |

EAC

| | |
|----------------------|--|
| Товар сертифицирован | :  |
| Дата производства | : Дата изготовления устройства определяется по двум буквенным обозначениям из второй группы символов серийного номера изделия, следующих после разделительного знака «-». Кодировка соответствует порядку букв латинского алфавита, начиная с января 2010 года: 000000-MY00000000, где «M» - месяц производства (А - январь, В - февраль, С - март и т.д.) и «Y» - год производства (А - 2010, В - 2011, С - 2012 и т.д.). |

FREE

Quick Start Guide

Guide de démarrage rapide

IC RF Exposure Information and Statement

The SAR limit of Canada (C) is 1.6 W/kg averaged over one gram of tissue. Device types: (IC: 6132A-JBLFREEEX) has also been tested against this SAR limit. According to this standard, the highest SAR value reported during product certification for head use is 0.049 W / kg.

The device was tested for typical bodily operations where the product was kept 5 mm from the head. To maintain compliance with IC RF exposure requirements, use accessories that maintain a separation distance of 0mm between the user's head and the back of the headset. The use of belt clips, holsters and similar accessories shall not contain metal parts in its assembly. Use of accessories that do not meet these requirements may not comply with IC RF exposure requirements and should be avoided.

Head operation

The device was subjected to a typical head manipulation test. In order to comply with RF exposure requirements, a minimum separation distance of 0 cm must be maintained between the user's ear and the product (including the antenna). Head exposure that do not meet these requirements may not meet RF exposure requirements and should be avoided. Use only the supplied or approved antenna.

IC: 6132A-JBLFREEEX

Informations et énoncés sur l'exposition RF de l'IC.

La limite DAS du Canada (C) est de 1,6 W/kg, arrondie sur un gramme de tissu. Types d'appareils: (IC: 6132A-JBLFREEEX) a également été testé en relation avec cette limite DAS selon ce standard. La valeur DAS la plus élevée mesurée pendant la certification du produit pour une utilisation au niveau de la tête est de 0,049 W / kg.

L'appareil a été testé dans des cas d'utilisation typiques en relation avec le corps, où le produit a été utilisé à 5 mm de la tête. Pour continuer à respecter les standards d'exposition RF de l'IC, utilisez des accessoires qui maintiennent une distance de séparation de 0 mm entre la tête de l'utilisateur et l'arrière du casque. L'utilisation de clips de ceinture, d'étui ou d'accessoires similaires ne doivent pas contenir de pièces métalliques. Les accessoires ne respectant pas ces exigences peuvent ne pas respecter les standards d'exposition RF de l'IC et doivent être évités.

Utilisation au niveau de la tête

L'appareil est testé dans un cas d'utilisation typique autour de la tête. Pour respecter les standards d'exposition RF, une distance de séparation minimum de 0 cm doit être maintenue entre l'oreille et le produit (antenne comprise). L'exposition de la tête ne respectant pas ces exigences peut ne pas respecter les standards d'exposition RF et doit être évité. Utilisez uniquement l'antenne incluse ou une antenne certifiée.

IC: 6132A-JBLFREEEX

FCC AND IC STATEMENT FOR USERS

THIS DEVICE COMPLIES WITH PART 15 OF THE FCC RULES. OPERATION IS SUBJECT TO THE FOLLOWING TWO CONDITIONS: (1) THIS DEVICE MAY NOT CAUSE HARMFUL INTERFERENCE, AND (2) THIS DEVICE MUST ACCEPT ANY INTERFERENCE RECEIVED, INCLUDING INTERFERENCE THAT MAY CAUSE UNDESIRE OPERATION. CAN ICES-3 (B) / NMB-3 (B).

FEDERAL COMMUNICATION COMMISSION INTERFERENCE STATEMENT

THIS EQUIPMENT HAS BEEN TESTED AND FOUND TO COMPLY WITH THE LIMITS FOR A CLASS B

FREE

Quick Start Guide

Guide de démarrage rapide

DIGITAL DEVICE, PURSUANT TO PART 15 OF THE FCC RULES. THESE LIMITS ARE DESIGNED TO PROVIDE REASONABLE PROTECTION AGAINST HARMFUL INTERFERENCE IN A RESIDENTIAL INSTALLATION. THIS EQUIPMENT GENERATES, USES AND CAN RADIATE RADIO FREQUENCY ENERGY AND, IF NOT INSTALLED AND USED IN ACCORDANCE WITH THE INSTRUCTIONS, MAY CAUSE HARMFUL INTERFERENCE TO RADIO COMMUNICATIONS. HOWEVER, THERE IS NO GUARANTEE THAT INTERFERENCE WILL NOT OCCUR IN A PARTICULAR INSTALLATION. IF THIS EQUIPMENT DOES CAUSE HARMFUL INTERFERENCE TO RADIO OR TELEVISION RECEPTION, WHICH CAN BE DETERMINED BY TURNING THE EQUIPMENT OFF AND ON, THE USER IS ENCOURAGED TO TRY TO CORRECT THE INTERFERENCE BY ONE OR MORE OF THE FOLLOWING MEASURES:

- REORIENT OR RELOCATE THE RECEIVING ANTENNA.
- INCREASE THE SEPARATION BETWEEN THE EQUIPMENT AND RECEIVER.
- CONNECT THE EQUIPMENT INTO AN OUTLET ON A CIRCUIT DIFFERENT FROM THAT TO WHICH THE RECEIVER IS CONNECTED.
- CONSULT THE DEALER OR AN EXPERIENCED RADIO/TV TECHNICIAN FOR HELP.

INSTRUCTIONS FOR USERS ON REMOVAL, RECYCLING AND DISPOSAL OF USED BATTERIES

FOR PRODUCTS WITH A BUILT-IN BATTERY THAT LASTS FOR THE LIFETIME OF THE PRODUCT, REMOVAL MAY NOT BE POSSIBLE FOR THE USER. IN THIS CASE, RECYCLING OR RECOVERY CENTERS HANDLE THE DISMANTLING OF THE PRODUCT AND THE REMOVAL OF THE BATTERY. IF, FOR ANY REASON, IT BECOMES NECESSARY TO REPLACE SUCH A BATTERY, THIS PROCEDURE MUST BE PERFORMED BY AUTHORIZED SERVICE CENTERS.

IN THE EUROPEAN UNION AND OTHER LOCATIONS, IT IS ILLEGAL TO DISPOSE OF ANY BATTERY WITH HOUSEHOLD TRASH. ALL BATTERIES MUST BE DISPOSED OF IN AN ENVIRONMENTALLY SOUND MANNER. CONTACT YOUR LOCAL WASTE-MANAGEMENT OFFICIALS FOR INFORMATION REGARDING THE ENVIRONMENTALLY SOUND COLLECTION, RECYCLING AND DISPOSAL OF USED BATTERIES.

WARNING: DANGER OF EXPLOSION IF BATTERY IS INCORRECTLY REPLACED. TO REDUCE RISK OF FIRE OR BURNS, DON'T DISASSEMBLE, CRUSH, PUNCTURE, SHORT EXTERNAL CONTACTS, EXPOSE TO TEMPERATURE ABOVE 60°C (140°F), OR DISPOSE OF IN FIRE OR WATER. REPLACE ONLY WITH SPECIFIED BATTERIES.

THE SYMBOL INDICATING 'SEPARATE COLLECTION' FOR ALL BATTERIES AND ACCUMULATORS SHALL BE THE CROSSED-OUT WHEELED BIN SHOWN BELOW:



IN CASE OF BATTERIES, ACCUMULATORS AND BUTTON CELLS CONTAINING MORE THAN 0.0005% MERCURY, MORE THAN 0.002% CADMIUM OR MORE THAN 0.004% LEAD, SHALL BE MARKED WITH THE CHEMICAL SYMBOL FOR THE METAL CONCERNED: Hg, Cd, OR Pb RESPECTIVELY. PLEASE REFER TO THE BELOW SYMBOL:



FREE

Quick Start Guide

Guide de démarrage rapide

WARNING

DO NOT ATTEMPT TO OPEN, SERVICE, OR DISASSEMBLE THE BATTERY | DO NOT SHORT CIRCUIT | MAY EXPLODE IF DISPOSED OF IN FIRE | RISK OF EXPLOSION IF BATTERY IS REPLACED BY AN INCORRECT TYPE | DISPOSE OR RECYCLE USED BATTERIES ACCORDING TO THE INSTRUCTIONS

低功率射頻電機警語標示內容：「(1)經型式認證合格之低功率射頻電機，非經許可，公司、商號或使用者均不得擅自變更頻率、加大功率或變更原設計之特性及功能。(2)低功率射頻電機之使用不得影響飛航安全及干擾合法通信；經發現有干擾現象時，應立即停用，並改善至無干擾時方得繼續使用。前項合法通信，指依電信法規定作業之無線電通信。低功率射頻電機須忍受合法通信或工業、科學及醫療用電波輻射性電機設備之干擾。」

해당무선설비는전파혼신가능성이있으므로인명안전과관련된서비스는할수없음

Este equipamento não tem direito à proteção contra interferência prejudicial e não pode causar interferência em sistemas devidamente autorizados.

Este produto está homologado pela ANATEL, de acordo com os procedimentos regulamentados pela Resolução 242/2000, e atende aos requisitos técnicos aplicados. Para maiores informações, consulte o site da ANATEL – www.anatel.gov.br



The Bluetooth® word mark and logos are registered trademarks owned by Bluetooth SIG, Inc. and any use of such marks by HARMAN International Industries, Incorporated is under license. Other trademarks and trade names are those of their respective owners.



